

# AVE-TVI704/08/16HD

HD-TVI DVR

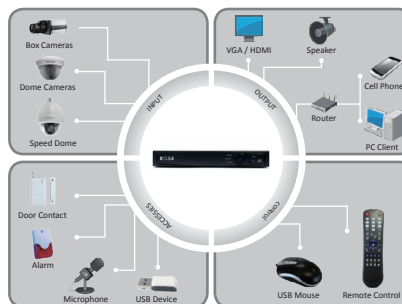

AMERICAN VIDEO EQUIPMENT

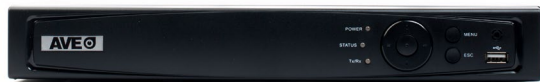

### Key features

- H.264 & Dual-stream video compression
- Support both HD-TVI and analog cameras with adaptive access
- Full channel@720P resolution real-time recording
- HDMI and VGA output at up to 1920x1080P resolution
- Long transmission distance over coax cable
- Support up to 16-ch synchronous playback at 1080P resolution

### Rear Panel

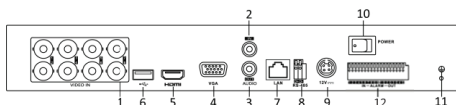

- 1 VIDEO IN
- 2 AUDIO IN, RCA Connector
- 3 AUDIO OUT, RCA Connector
- 4 VGA Interface
- 5 HDMI Interface
- 6 USB Port
- 7 LAN Network Interface
- 8 RS-485 Serial Interface
- 9 12VDC Power Input
- 10 Power Switch
- 11 GND
- 12 Alarm I/O

	AVE-TVI704HD	AVE-TVI708HD	AVE-TVI716HD
<b>Video/Audio input</b>			
Video compression	H.264		
Analog and HD-TVI video input	4-ch	8-ch	16-ch
Supported camera types	720P25, 720P30, 720P50, 720P60, 1080P25, 1080P30, CVBS		
Audio compression	G.711u		
Audio input / Two-way audio in	4-ch, RCA (2.0 Vp-p, 1 KΩ)		
<b>Video/Audio output</b>			
HDMI / VGA output	1920 × 1080 / 60 Hz, 1280 × 1024 / 60 Hz, 1280 × 720 / 60 Hz, 1024 × 768 / 60 Hz		
Encoding resolution	Main stream: 1080P(non-real-time) / 720P / VGA / WD1 / 4CIF / QF Sub-stream: WD1(non-real-time) / 4CIF(non-real-time) / CIF / QCF / QVGA		
Frame rate	Main stream: 1/16 fps ~ Real time frame rate Sub-stream: 1/16 fps ~ Real time frame rate		
Video bitrate	32 Kbps-6 Mbps		
Audio output	1-ch, RCA (Linear, 1KΩ)		
Audio bitrate	64 Kbps		
Dual-stream	Support		
Stream type	Video, Video & Audio		
Synchronous playback	4-ch	8-ch	16-ch
Playback resolution	1080P / 720P / VGA / WD1 / 4CIF / CIF / QVGA / QCIF		
<b>Network management</b>			
Remote connections	128		
Network protocols	TCP/IP, PPPoE, DHCP, DNS, DDNS, NTP, SADP, SMTP, SNMP, NFS, iSCSI, UPnP™, HTTPS		
<b>Hard disk</b>			
Type	4 SATA interfaces for 4 HDDs; 1 eSATA interface		
SATA	1 SATA interface	2 SATA interfaces	
Capacity	Up to 4 TB capacity for each disk		
<b>External interface</b>			
Network interface	1; 10M / 100M self-adaptive Ethernet interface		1; 10M / 100M / 1000M self-adaptive Ethernet interface
Serial interface	1; standard RS-485 serial interface, half-duplex		
USB port	2 × USB2.0		
Alarm in/out	4/1	8/4	16/4
<b>General</b>			
Power supply	12V DC		
Consumption (without hard disks)	≤ 15W	≤ 20W	≤ 20W
Working temperature	-10 °C ~+55 °C (14 °F ~ 131 °F)		
Working humidity	10% ~ 90%		
Chassis	1U chassis		380mm 1U chassis
Dimensions (W × D × H)	315 × 242 × 45mm (12.4 × 9.5 × 1.8 inch)		380 × 290 × 48mm (15.0 × 11.4 × 1.9 inch)
Weight (without hard disks)	≤ 1.5Kg (3.3lb)		≤ 2Kg (4.4lb)



**AVE (Europe)** 123 Millennium Business Park, Ballycoolin, Dublin 11, Rep. Of Ireland.  
**AVE (UK)** Tel: +353 (1) 8647450 Fax: +353 (1) 8647451 Email: eusales@ave-global.com Web: www.ave-global.com  
 Endeavour House, Coopers End Road, Stansted, Essex, CM24 1SJ  
**AVE (USA)** Tel: +44 (0)845 600 9323 Fax: +44 (0)845 600 9363 Email: eusales@ave-global.com Web: www.ave-global.com  
 2300 Central Parkway, Suite C, Houston, Texas TX 77092  
**AVE (Asia)** Tel: +1 (281) 443 2300 Fax: +1 (281)-443-8915 Email: usasales@ave-global.com Web: www.ave-global.com  
 147 Soi OnNut44, (Sampheengong Villa), Sukhumvit 77Rd., Suanluang, Suanluang, Bangkok 10250 Thailand.  
 Tel: +662-331-9285 Fax: +662 331 9365 Email: ave@avethailand.com Web: www.avethailand.com